

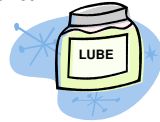

## RANDY BUTT - REST IN PEACE

By solving his bloody murder!



On: \_\_\_\_\_

Location: \_\_\_\_\_

Time: \_\_\_\_\_

Tel: \_\_\_\_\_ Email: \_\_\_\_\_



### RSVP



Randy Butt, muscle-bound dancer at the gay club "The Pink Pelican", has been found brutally murdered, stabbed in the side of the neck. One of eight suspects has committed the crime.

#### Jasper Daniels, 53,

Cigar Smoking, Brandy Swilling Club Manager

#### Cissy Scratch-Hard, 33,

Razor Sharp Tongued, Razor Sharp Finger Nailed Drag Queen



#### Philip Starr, 35,

Snappy Dressing, Career Minded Assistant Manager

#### Drew Anderson, 23,

Handsome, Shy, Gorgeously Leg Muscled Footballer



#### Mikey McDowell, 23,

Cute, Blond, Emotionally Unstable Bar Boy

#### Hamish Hudson, 56,

Oversexed, Luxury Loving, Well Hung, Dissipated Journalist

#### Luke O'Shay, 25,

Lean, Mean, Masculine, Leather Loving Bar Boy

#### Sir Compton Clarke, 65,

Immensely Wealthy, Strongly Opinionated Newspaper Tycoon



One of the above eight suspects murdered Randy. You are invited to help

#### Ben Bulge, 34,

Private Investigator and Night Club Security Specialist

### Discover Whodunit!



## BACKGROUND

Randy Butt's dead body was discovered at 1.10 am in the Main Office of the Pink Pelican nightclub by Mr Philip Starr, the club's Assistant Manager. Mr Starr immediately raised the alarm. Only the eight suspects were in the club at the time of the murder.

Sir Compton Clarke, who owns the club, decided that in the interests of preventing a damaging scandal, he would ask the club's security officer, Ben Bulge, to undertake a preliminary investigation before calling in the police. Ben, a former Police Officer, now runs his own security company.

Upon arriving at the club with some of his staff, Ben surveyed the body. Mr Butt was lying face down and a knife was still embedded in the left hand side of his neck. Ben deduced that he had been stabbed from behind and that death would have been instantaneous. He also noted a recent bruise to Mr Butt's lower left jaw which looked as though it had been caused by a fist.

Upon interviewing the suspects, two people said they overheard Mr Butt quarrelling with someone shortly before his death.

Philip Starr stated that he was in the Filing Room shortly after 1.00 am. Through the wall he could hear two people arguing extremely violently in the Main Office. One of these people was Randy Butt. Philip could not identify the other person.

The argument ended abruptly and Philip thinks he heard a choked cry. He then heard the Main Office door opening, being slammed shut, then footsteps disappearing rapidly down the corridor. After waiting uneasily in the Filing Room for a few minutes, Philip entered the Main Office and discovered the body of Randy Butt.

Sir Compton Clarke stated that shortly after 1.00 am he was in the club Rest Room, waiting for drag queen Cissy Scratch-Hard to finish changing, as he had promised her a lift home. Through the door that connects the Rest Room with the Main Office he also heard Randy Butt having a violent quarrel. Sir Compton, who is slightly deaf, thinks he recognised the voice of the other person. However, as he is not one hundred percent sure, he has elected to mention no names. He agrees that the argument ended abruptly and that someone came out of the Office, slammed the door, and walked hurriedly past the Rest Room door.

However the six other suspects all deny being the person overheard quarrelling with Randy and declare that between 1.00 am and 1.10 am they were elsewhere.

**Jasper Daniels** states that he was in the Storage Room, looking out some props for the next night's cabaret artiste.

**Cissy Scratch-Hard** states she was changing in her dressing room, prior to leaving with Sir Compton.

**Luke O'Shay** states that he was in the Bar Storage area, doing some last minute tidying.

**Hamish Hudson** states that he was in the Cruising Lounge, waiting to say goodnight to Sir Compton and Cissy.

**Drew Anderson** states that he was also in the Cruising Lounge. Both he and Hamish Hudson confirm each others alibis.

**Mikey McDowell** was unable to state where he was, but thought it might have been the gents' toilets. The other suspects confirm that, after the body was discovered, they found him lying against the toilet wall, seemingly senseless from drink.

A plan of the club, with everyone's stated position is attached.

It is now 2.00 am. Ben, with the aid of some of his work colleagues, has decided that they have until dawn to solve the mystery. If, by daybreak, the murderer is still unknown, Ben will hand the investigation over to the police. The only action Ben has so far taken is to remove the weapon and test it for fingerprints. Although the knife has been wiped, one half smudged fingerprint has not been removed. Upon taking the prints of the eight suspects, the print on the knife has been matched with a fingerprint belonging to Philip Starr.

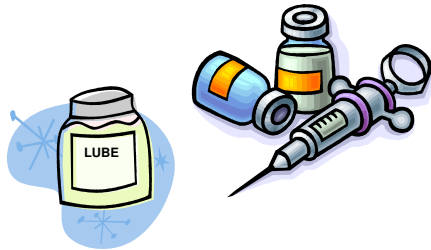

## MAP OF PINK PELICAN NIGHTCLUB

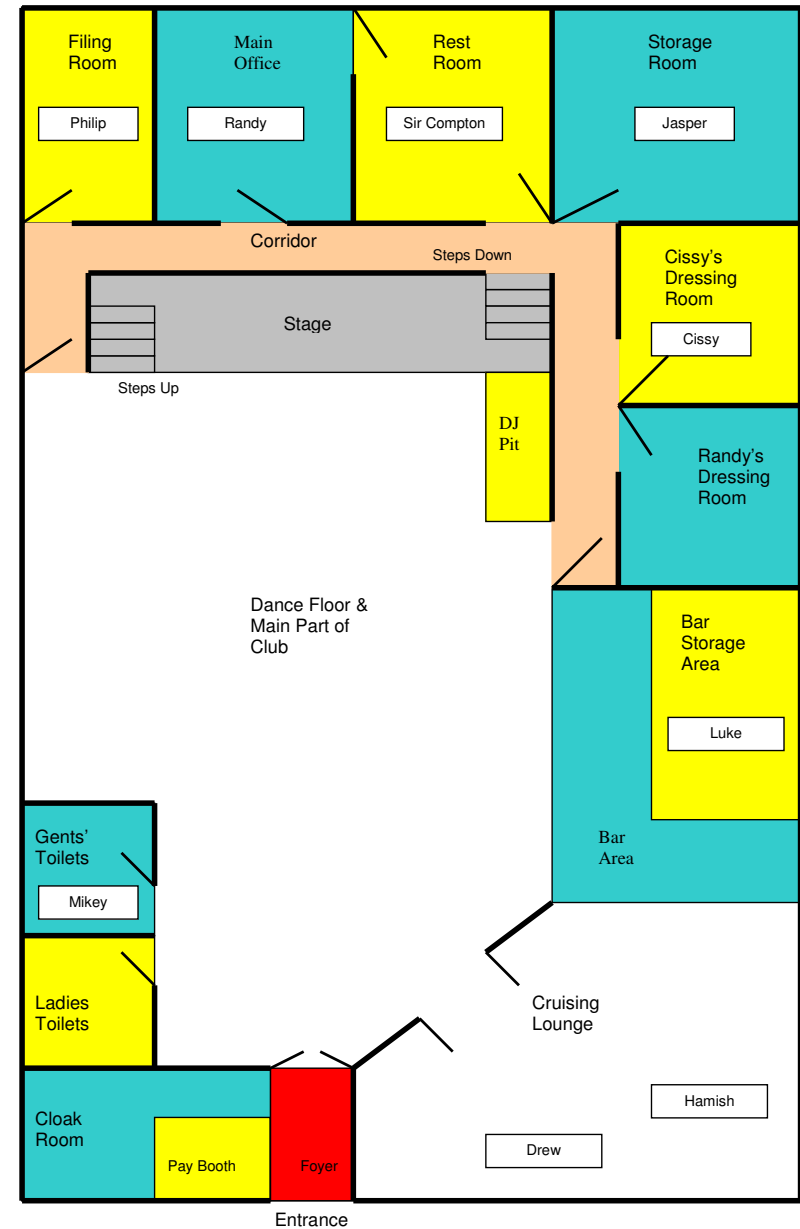

### HOW THE GAME WORKS

The original “Randy Butt - RIP” merrymurder was designed for between 10 and 13 players. In this version each player would represent a particular character and come to the party suitably dressed.

This version of “Randy Butt - RIP” has been specially adapted so that it can be played with a smaller number of players around a dining table.

On the night of the party there will be between 5 and 9 players. These players will be split into 5 teams, known as Team A, Team B, Team C, Team D and Team E respectively. Each team will therefore contain either one or two players.

Each team will be providing the voices of some of the characters:

- Team A will be voicing Ben Bulge. They will also be asking all the investigation questions.
- Team B will be voicing the parts of Jasper Daniels and Drew Anderson.
- Team C will be voicing the parts of Philip Starr and Mikey McDowell.
- Team D will be voicing the parts of Hamish Hudson and Luke O'Shay.
- Team E will be voicing the parts of Cissy Scratch-Hard and Sir Compton Clarke.

If there are two players in a team, they can each provide the voice of a suspect. If there is only one player in a team, he or she will have to voice both suspects.

The game is played over 4 rounds. During these rounds questions will be asked and answers revealed. And clue items will be discovered that will help throw light on Randy Butt's murder.

At the end of the game everyone must give their opinion as to which of the eight suspects committed the murder. The killer will then be revealed in a dramatic denouement speech. Finally the killer(s) will confess.

The whole game should take about 3 hours to play.

### ALSO AVAILABLE FROM WWW.MERRYMURDER.COM

<b>CARDS ON THE TABLE</b> 4-5 players Slaughtering spades, homicidal hearts, death dealing diamonds and killer clubs.	<b>THE PUNGENT PUMPKIN POISONER</b> 8-10 players An impromptu murder mystery. <b>DOWNLOADABLE FREE</b>
<b>THE MURDER OF MRS WHYTE</b> 8-13 players A horticultural murder mystery, inspired by a famous board game.	<b>NATURAL PORN KILLERS</b> 4-8 or 9-12 players A murder mystery set in the world of blue movies - Adults only.
<b>TEN LITTLE VAMPIRES</b> 10 players Ten little vampires going out to dine, one choked his little self and then there were nine	<b>RANDY BUTT – RIP</b> 10-13 players A fantastic gay murder mystery – Lechery, lust, and copping off – Adults only.
<b>AN EASTER EXTRAVAGANZA</b> 5-10 or 11-15 players An egg inspired murder. Who cracked open Sergei Shell's head at his Easter Fair?	<b>DEATH BY DEPRECIATION</b> 11-16 players An accountancy murder. Fatal finance, crooked accountants & murderous money.
<b>SING A LONG A SOUND OF MURDER</b> 11-17 players A murder mystery crossed with a musical. Who killed Herr Zealot, head of the Nazis?	<b>THE WOMAN IN THE IRON MASK</b> 12-16 players A French Revolution mystery. Louis XV's mistresses & musketeers solve a beheading.
<b>THE WAKE FOR HUMPTY DUMPTY</b> 12-16 players Did Humpty fall? Or was he pushed? No one in Nursery Rhyme Town is shedding tears.	<b>THE MERRYMURDER PANTOCRIME</b> 12-18 players A murder mystery crossed with a pantomime. Good magic, bad jokes and ugly sisters.
<b>THE CUTTING IT KILLER</b> 13-16 players Sexing up the salon. Hollywood hair styles. Drugs with the dyes. And much, much more!	<b>SLAUGHTER AT THE CIRCUS</b> 13-18 players A tale of sabotage, diamonds, insatiable passion, lions, red noses, tarot and carcasses.
<b>MURDER AT THE NORTH POLE</b> 14-18 players Father Christmas? Mrs Christmas? Rudolph? One North Pole resident is a heartless killer...	<b>ORGY OF DEATH</b> 16-20 players A Roman murder mystery – Has a sex game gone wrong or is it murder. Adults only.